

Product information presented here reflects conditions at time of publication. Consult factory regarding discrepancies or inconsistencies.

MODEL 2522

PRODUCT FEATURES 1 HP Effluent Pumps

60 Hz

visit our website:
zoellerpumps.com

APPLICATIONS

- Effluent handling
- Dewatering
- Water transfer

MATERIAL FEATURES

PUMP:

- Cast iron ASTM A48 Class 30
- 1-1/2" NPT discharge
- Double carbon / ceramic mechanical seal
- Thermal overload is mounted directly on the windings in the single phase models for maximum temperature sensing
- Attaching hardware - 304 stainless steel
- The cord seal is epoxy-potted for superior moisture resistance and anti-wicking
- Ductile iron impeller for superior quality and long life
- Semi-open impeller design reduces bearing load, increases bearing life and prevents clogging
- Passes 3/4" (19 mm) spherical solids

MOTOR:

- 1 HP, 3450 RPM
- 1 Phase - 230 Volt
- Stator - Class B insulation and lead wires Nema B design
- Oil-filled motor for better cooling and lubrication
- Integral thermal overload
- Housing - cast iron
- Power cable length - 30' (9 m)
- Ball bearings - upper and lower high carbon chromium steel

FEATURES

1. 30' (9 m) power cord.
2. Cast iron support legs enable the pump to be free-standing.
3. Stainless steel lifting bail.
4. Stator - Class B insulation and lead wires Nema B design. Class B motor insulation is double-dipped and baked.
5. Thermal sensor protection mounted directly on the windings to protect against overheating.
6. Upper and lower high carbon chromium steel ball bearings.
7. Stainless steel shaft and hardware resist corrosion.
8. Buna-N O ring seals.
9. Triple sealed design compression grommet - outer jacket seal epoxy potted - inner conductor seal.
10. Cast iron ASTM A48 Class 30 strength.
11. Double carbon / ceramic mechanical seal.
12. Semi-open impeller design, fully balanced with integral pump-out vane to clear debris.
13. 1-1/2" NPT discharge. Concentric pump housing with centerline discharge reduces radial loading for longer bearing and shaft seal life.

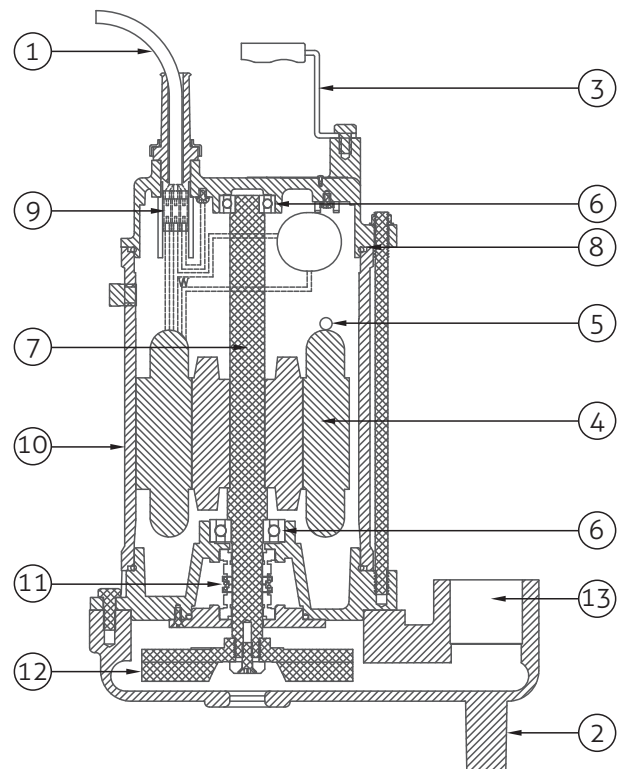

EA0151

MODEL 2522

TECHNICAL DATA

1 HP Effluent Pumps

MODELS:	<input type="checkbox"/> 2242
MODE:	NON-AUTO
PUMP NAME PLATE HORSEPOWER:	1
MAXIMUM KW INPUT:	3.3
STANDARD IMPELLER DIAMETER:	5.217" (132.5 mm)
DISCHARGE SIZE:	1-1/2" NPT

IMPELLER TYPE:	SEMI-OPEN	DOUBLE SEALS:	STANDARD
SOLID SIZE:	3/4" (19 mm)	MOTOR DESIGN LETTER:	NEMA B
PUMP NET WEIGHT:	73 lbs. (33 kg)	POWER CORD LENGTH: ft (m) (30' [9 m] STANDARD)	<input type="checkbox"/> 50' (15.2 m)
O RINGS:	BUNA-N	POWER CORD:	14 GAUGE SJTW
MOTOR SHAFT:	SS410	STATOR & LEAD WIRES INSULATION:	CLASS B
RPM:	3450	MAXIMUM STATOR TEMPERATURE:	266 °F (130 °C)
MOTOR TYPE:	SUBMERSIBLE		

SHAFT SEAL CONSTRUCTION:	STANDARD	CARBON/CERAMIC
STANDARD SENSING DEVICES:	MOTOR THERMAL SHUTOFF	INTEGRAL ON-LEAD
IMPELLER MATERIAL:	2522	STANDARD DUCTILE IRON
IMPELLER TRIM:	<input type="checkbox"/> OPTIONAL	DESIGN POINT: ____ GPM @ ____' TDH, IMPELLER DIA. ____"
MAXIMUM WATER TEMPERATURE:		140 °F (60 °C)

MODEL	HP	<input type="checkbox"/> 230V / 1 PH	
		FLA	LRA
2522	1	14	53

RESERVE POWERED DESIGN

For unusual conditions a reserve safety factor is engineered into the design of every Zoeller® pump.

MODEL 2522
PERFORMANCE CURVE
1 HP Effluent Pumps

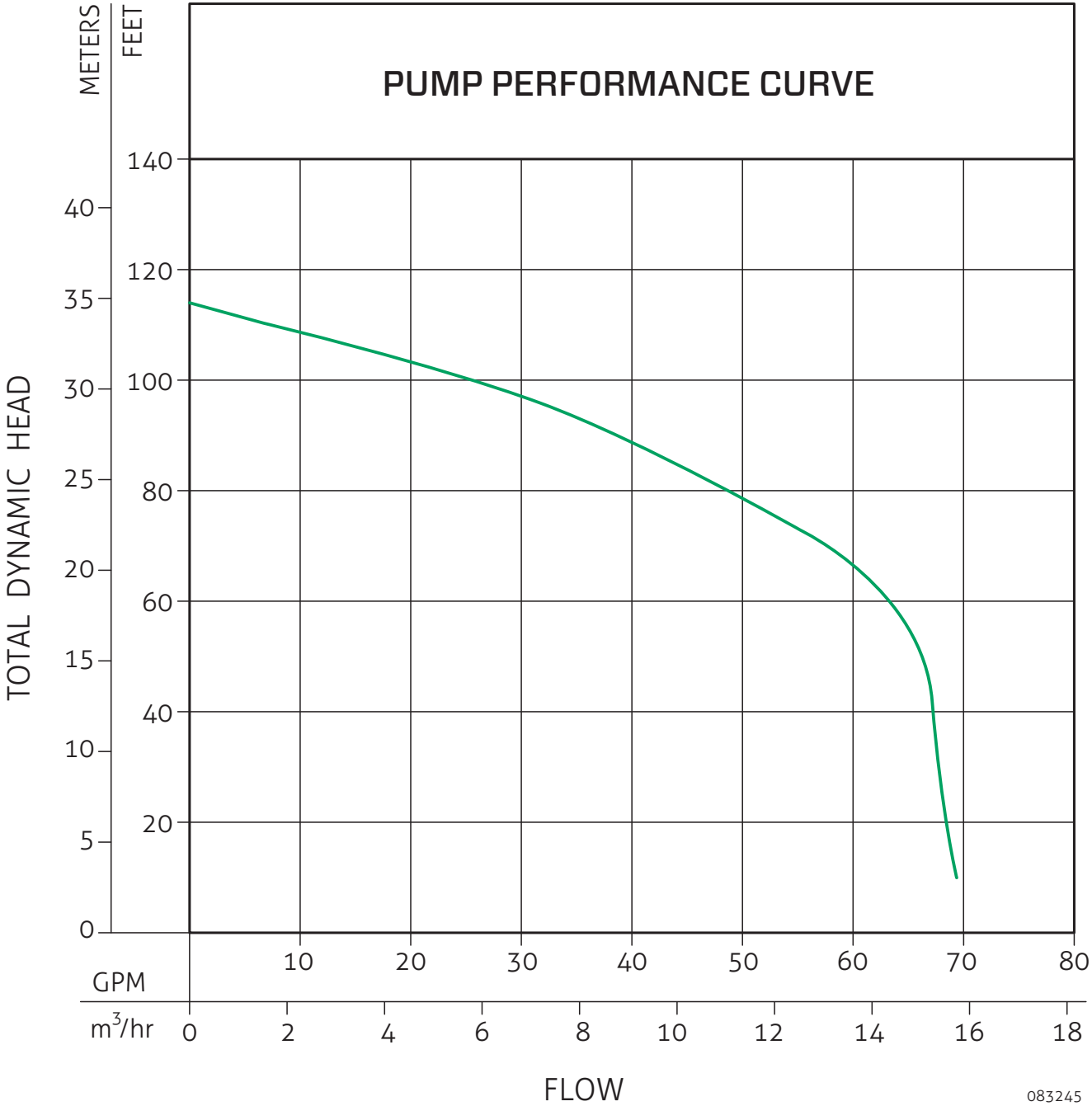

083245

MODEL 2522

DIMENSIONAL DRAWING

1 HP Effluent Pumps

