

Models LU70, LM70, LD70

Submersible Sump Pumps

50 Hz 60 Hz

Automatic Operation:

- This lightweight, portable pump has a built-in sensor that automatically looks for the presence of water on 3-minute intervals. When water is detected, the pump will run until all water is removed and the cycle is repeated. This feature makes the pump ideal for areas prone to flooding such as basements and construction sites where water removal is necessary after a rainfall.

Features:

- Electronic control for automatic operation
- Thermal overload protected motor for long life
- Engineered thermoplastic and stainless steel components provide improved corrosion resistance
- Vent hole prevents air lock
- Non-clogging vortex impeller passes up to 3/8" (9 mm) spherical solids
- Carrying handle for convenient pump placement
- Maximum operating water temperature 104 °F (40 °C)

Applications:

- Basement water removal
- Construction site water removal
- Wastewater drainage
- Water supply for agriculture irrigation and landscape
- Lake/River water transfer

100% factory tested



Trusted. Tested. Tough.®



ZT0447_Ec
0423
Supersedes
NEW

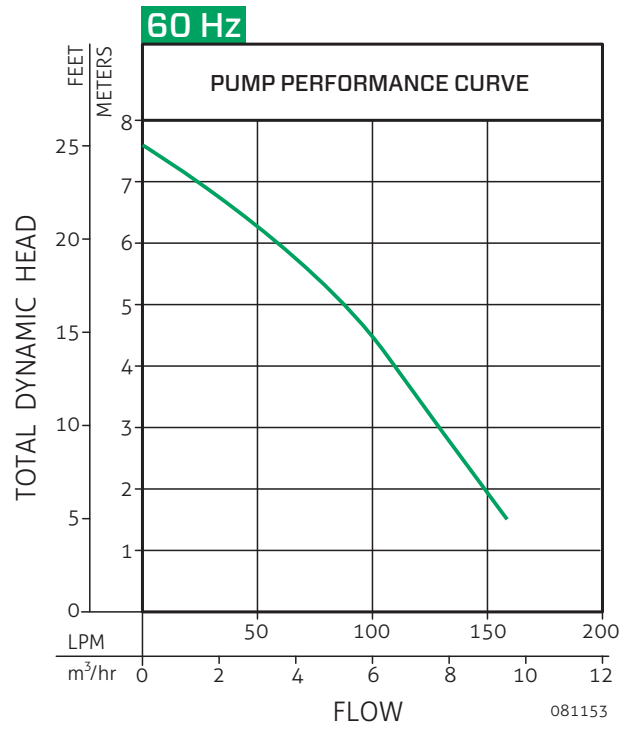
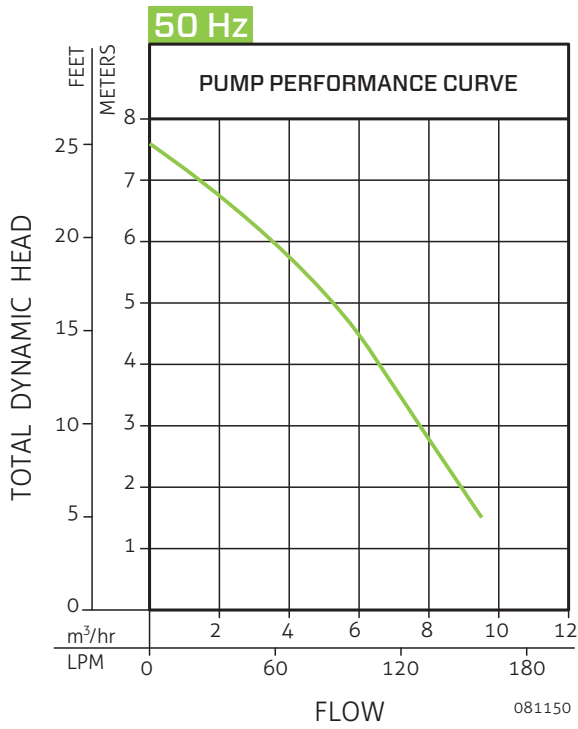

50 Hz

Model	Mode	Volt (V)	Ph Ø	Amps (A)	Motor		Weight		Switch Point			
					kW (p1)	HP	kg	lbs	On		Off	
									inch	mm	inch	mm
LU70	Auto	220	1	2.2	0.44	1/3	5.1	11.2	1-3/16	30	5/8	15

60 Hz

Model	Mode	Volt (V)	Ph Ø	Amps (A)	Motor		Weight		Switch Point			
					HP	kW (p1)	kg	lbs	On		Off	
									inch	mm	inch	mm
LM70	Auto	115	1	5.5	1/3	0.50	5.1	11.2	1-3/16	30	5/8	15
LD70	Auto	230	1	2.2	1/3	0.52	5.1	11.2	1-3/16	30	5/8	15

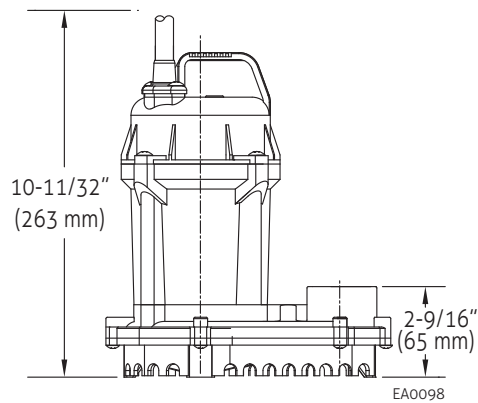
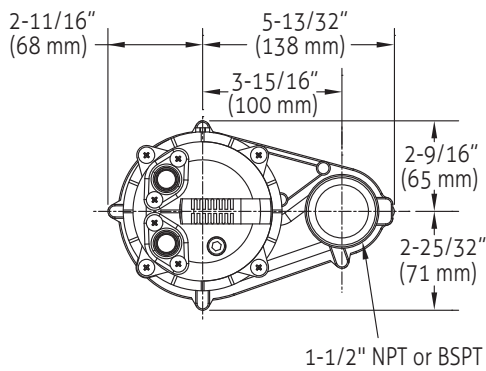

Product information presented here reflects conditions at time of publication. Consult factory regarding discrepancies or inconsistencies.