

Models 2763, 2765 & 2767 Submersible Grinder Pump

50 Hz 60 Hz

Features:

- Hardened 440 stainless steel (56-60 Rockwell) shredding ring and grinding impeller
- Cast iron ASTM A48 Class 30
- Recessed vortex impeller design reduces bearing load, increases bearing life and prevents clogging
- Ductile iron impeller for superior quality and long life
- Thermal sensor protection (three phase) mounted directly on the windings to protect against overheating
- Tandem carbon / ceramic & SIC / SIC mechanical seal for longer pump life in challenging applications
- Moisture probes for leak detection (requires circuit in control panel to function) to signal the need for preventive maintenance
- Oil-filled motor for better cooling and lubrication
- The cord seal is epoxy-potted for superior moisture resistance and anti-wicking
- 3" horizontal flange
- 10 m (33') cord (50 Hz) / 9 m (30') cord (60 Hz)

Applications:

- Low pressure sewer systems
- High head sewage systems
- Domestic, commercial, wastewater and sewage

100% factory tested



Trusted. Tested. Tough.®



ZT0283_Ec
0721
Supersedes
0121

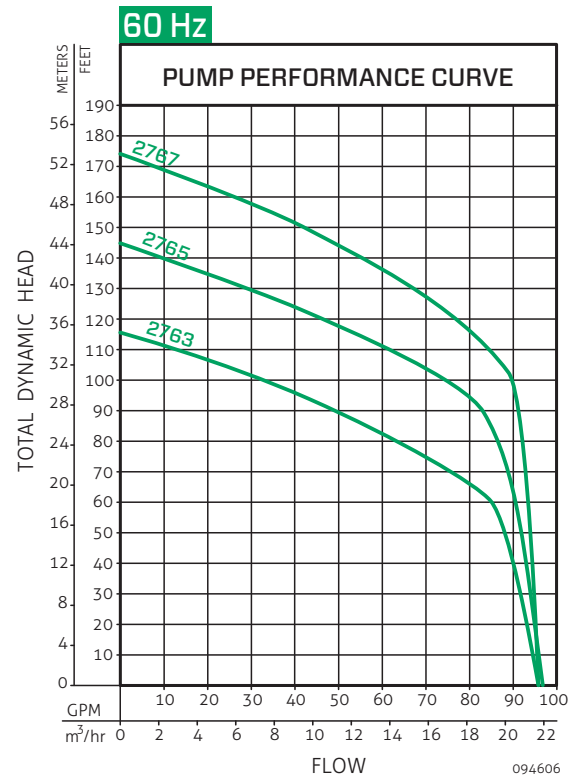
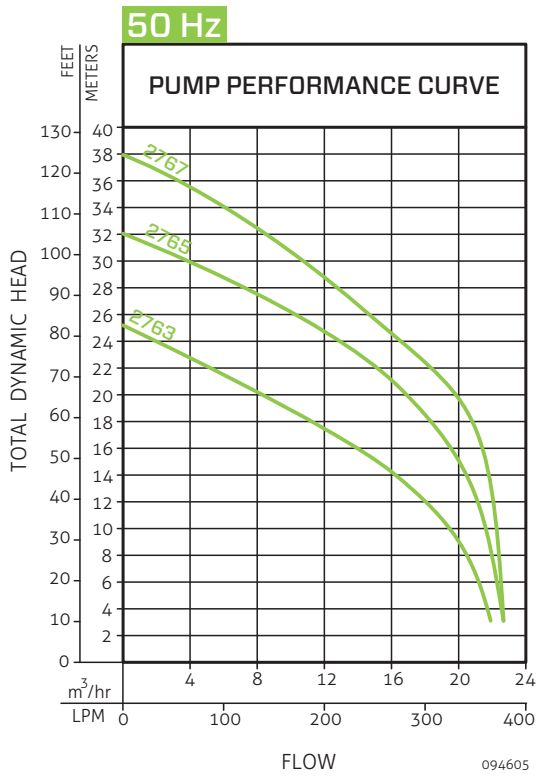

50 Hz

Model	Mode	Volts (V)	Ph Ø	Amps (A)	Motor		Weight	
					HP	kW (p1)	kg	lbs
AK2763	Non-Auto	380	3	7.0	3	3.6	92	203
AK2765	Non-Auto	380	3	8.5	5	4.6	92	203
AK2767	Non-Auto	380	3	10.0	7-1/2	5.6	92	203

60 Hz

Model	Mode	Volts (V)	Ph Ø	Amps (A)	Motor		Weight	
					HP	kW (p1)	kg	lbs
F2763	Non-Auto	230	3	15.5	3	5.1	92	203
K2763	Non-Auto	380	3	9.0	3	5.1	92	203
F2765	Non-Auto	230	3	19.0	5	6.6	92	203
K2765	Non-Auto	380	3	11.0	5	6.6	92	203
F2767	Non-Auto	230	3	22.0	7-1/2	8.0	92	203
K2767	Non-Auto	380	3	13.0	7-1/2	8.0	92	203

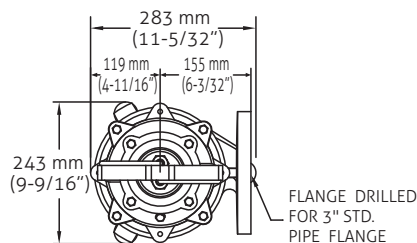

FLANGE DRILLED FOR 3" STD. PIPE FLANGE

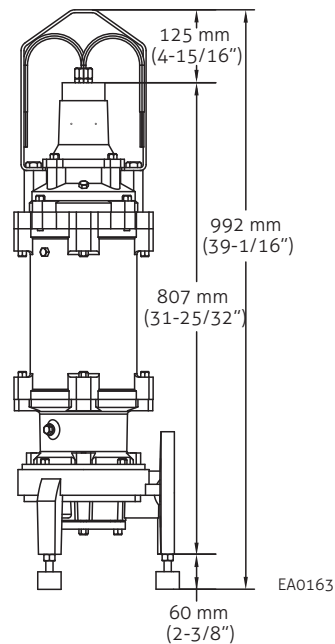

Product information presented here reflects conditions at time of publication. Consult factory regarding discrepancies or inconsistencies.