

Trusted. Tested. Tough<sup>®</sup>

Product information presented here reflects conditions at time of publication. Consult factory regarding discrepancies or inconsistencies.



**60 Hz**

Visit our website:  
[www.zoellerpumps.com](http://www.zoellerpumps.com)

Register your Zoeller Pump Company Product on our website:  
<http://reg.zoellerpumps.com/>

# DRAIN PUMP SYSTEM

## MODEL 132/133 (Preassembled)

### INSTALLATION INSTRUCTIONS

### PREINSTALLATION CHECKLIST

1. Inspect your pump. Occasionally, products are damaged during shipment. If the unit is damaged, contact your dealer before using. Do Not remove the test plug in the cover.
2. Carefully read the literature provided to familiarize yourself with specific details regarding installation and use. These materials should be retained for future reference.

<span style="font-size: 1.5em; font-weight: bold; border: 1px solid black; padding: 2px;">WARNING</span>	<span style="font-size: 1.5em; font-weight: bold; border: 1px solid black; padding: 2px;">CAUTION</span>
SEE BELOW FOR LIST OF WARNINGS	SEE BELOW FOR LIST OF CAUTIONS
<ol style="list-style-type: none"> <li>1. To reduce the risk of electrical shock, a properly grounded receptacle of grounding type must be installed and protected by a ground fault circuit interrupter (GFCI) and in accordance with local codes.</li> <li>2. Make certain that the receptacle is within the reach of the pump's power supply cord. <b>DO NOT USE AN EXTENSION CORD.</b> Extension cords that are too long or too light do not deliver sufficient voltage to the pump motor and could present a safety hazard if the insulation were to become damaged or the connection end were to fall into the sump.</li> <li>3. Testing for Ground. As a safety measure, each electrical outlet should be checked for ground using an Underwriters Laboratory Listed circuit analyzer which will indicate if the power, neutral and ground wires are correctly connected to your outlet. If they are not, call a qualified electrician.</li> <li>4. <b>FOR YOUR PROTECTION, ALWAYS DISCONNECT THE PUMP FROM ITS POWER SOURCE BEFORE HANDLING.</b> Single phase pumps are supplied with a 3-prong grounded plug to help protect you against the possibility of electrical shock. <b>DO NOT UNDER ANY CIRCUMSTANCES, REMOVE THE GROUND PIN.</b></li> <li>5. Installation and checking of electrical circuits and hardware should only be performed by a qualified licensed electrician.</li> </ol>	<ol style="list-style-type: none"> <li>1. Check to be sure your power source is adequate for handling the voltage requirements of the motor, as indicated on the pump or basin plate.</li> <li>2. Make sure the pump electrical supply circuit is equipped with fuses or circuit breakers of proper capacity. A separate branch circuit is recommended, sized according to the current shown on the pump nameplate.</li> <li>3. All plumbing (discharge and vent lines) must be installed to meet local codes. Unit must be vented. Some codes may require this unit to be installed by a qualified licensed plumber. <b>DO NOT USE AN AUTOMATIC PLUMBING VENT DEVICE.</b></li> <li>4. <b>CHECK VALVE MUST BE USED TO REDUCE UNNECESSARY CYCLING OF PUMP.</b></li> <li>5. Dewatering pumps are not designed or intended for handling raw sewage.</li> <li>6. Maximum operating temperature must not exceed 40°C.</li> <li>7. For health reasons, do not unplug, turn off, or disable pump and use pump tank system as a way to fill up a sink or laundry tray, etc.</li> <li>8. The rubber coupling used on the check valve is rated for 0.3 kg/cm<sup>2</sup> ( 3 m of head ) and a maximum temperature of 54.4°C, if the static head is more than 3 m, use glue fittings instead of the rubber couplings.</li> </ol>
<p><b>REFER TO WARRANTY ON PAGE 2.</b></p>	

**DO NOT USE FOR PUMPING OILS, GASOLINE OR ANY PETROLEUM BY-PRODUCTS.**

## Limited Warranty

Manufacturer warrants, to the purchaser and subsequent owner during the warranty period, every new product to be free from defects in material and workmanship under normal use and service, when properly used and maintained, for a period of one year from date of purchase by the end user, or 18 months from date of original manufacture of the product, whichever comes first. Parts that fail within the warranty period, one year from date of purchase by the end user, or 18 months from the date of original manufacture of the product, whichever comes first, that inspections determine to be defective in material or workmanship, will be repaired, replaced or remanufactured at Manufacturer's option, provided however, that by so doing we will not be obligated to replace an entire assembly, the entire mechanism or the complete unit. No allowance will be made for shipping charges, damages, labor or other Charges that may occur due to product failure, repair or replacement.

This warranty does not apply to and there shall be no warranty for any material or product that has been disassembled without

prior approval of Manufacturer, subjected to misuse, misapplication, neglect, alteration, accident or act of God; that has not been installed, operated or maintained in accordance with Manufacturer's installation instructions; that has been exposed to outside substances including but not limited to the following: sand, gravel, cement, mud, tar, hydrocarbons, hydrocarbon derivatives (oil, gasoline, solvents, etc.), or other abrasive or corrosive substances, wash towels or feminine sanitary products, etc. in all pumping applications. The warranty set out in the paragraph above is in lieu of all other warranties expressed or implied; and we do not authorize any representative or other person to assume for us any other liability in connection with our products.

MANUFACTURER EXPRESSLY DISCLAIMS LIABILITY FOR SPECIAL, CONSEQUENTIAL OR INCIDENTAL DAMAGES OR BREACH OF EXPRESSED OR IMPLIED WARRANTY; AND ANY IMPLIED WARRANTY OF FITNESS FOR A PARTICULAR PURPOSE AND OF MERCHANTABILITY SHALL BE LIMITED TO THE DURATION OF THE EXPRESSED WARRANTY.

**In those instances where damages are incurred as a result of an alleged pump failure, the Homeowner must retain possession of the pump for investigation purposes.**

## Service Checklist

 **WARNING** **ELECTRICAL PRECAUTIONS** - Before servicing a pump, always shut off the main power breaker and then unplug the pump - making sure you are not standing in water and wearing insulated protective sole shoes. Under flooded conditions, contact your local electric company or a qualified licensed electrician for disconnecting electrical service prior to pump removal.

Submersible pumps can become pressurized under normal operating conditions - allow 2.5 hours after disconnecting before attempting service.

CONDITION	COMMON CAUSES	REMEDY
A. Pump will not start or run.	Low voltage, blown fuse, open circuit	Have a electrician check house wiring.
	Impeller bound	Contact a Zoeller Distributor.
	Motor or wiring shorted	
	Debris on float switch	Remove debris.
B. Motor overheats and trips overload or blows fuse.	Incorrect voltage, negative head (discharge open lower than normal) impeller or seal bound mechanically, defective capacitor or relay, motor shorted.	Contact a Zoeller Distributor.
C. Pump starts and stops too often.	Float too tight on rod, check valve stuck, or none installed in long distance line, overload open, switch defective.	Contact a Zoeller Distributor.
D. Pump will not shut off.	Debris under float	Remove debris from around float.
	Faulty float switch	Contact a Zoeller Distributor.
E. Pump operates but delivers little or no water.	Debris around intake	Clean area around intake.
	Blockage in discharge pipe	Remove pipe and flush out debris.
	Low or incorrect voltage	Have a electrician check house wiring.
	Damaged Impeller	Contact a Zoeller Distributor.
	Incorrect motor rotation. Capacitor defective. Incoming water containing air or causing air to enter pumping chamber.	Contact a Zoeller Distributor.
	Pump is air locked	Make sure vent hole in discharge pipe is clear.
F. Drop in head and/or capacity after a period of use.	Vertical lift too high	Change discharge piping or Contact a Zoeller Distributor.
	Increased pipe friction, clogged line or check valve. Abrasive material and adverse chemicals could possibly deteriorate impeller and pump housing.	Check line. Remove base and inspect.
G. tank or fittings leak.		Carefully tighten pipe joints (use pipe dope) and screws. Check gasket location, tighten lid evenly. Do not over tighten fittings or screws.

**If the above checklist does not uncover the problem, consult the factory - Do not attempt to service or otherwise disassemble pump. Service must be by Zoeller Authorized Service Stations.**

## Helpful Hints For Easy Installation

- |                                                                                                                                                                                                                                                                                                                                              |                                                                                                                                                                                                                                                                                                                                                                     |
|----------------------------------------------------------------------------------------------------------------------------------------------------------------------------------------------------------------------------------------------------------------------------------------------------------------------------------------------|---------------------------------------------------------------------------------------------------------------------------------------------------------------------------------------------------------------------------------------------------------------------------------------------------------------------------------------------------------------------|
| <ol style="list-style-type: none"> <li>1. Read all instructions before beginning installation.</li> <li>2. Be certain that basin is on a firm level surface.</li> <li>3. Do not use an automatic plumbing vent device.</li> <li>4. Always use a check valve on the discharge line.</li> <li>5. Test operation of pump per STEP 3.</li> </ol> | <ol style="list-style-type: none"> <li>6. Always provide some means to disconnect basin from plumbing for maintenance purposes.</li> <li>7. Run unit at least once a month to verify proper operation.</li> <li>8. The model number and date code can be found on the lid warning label.</li> <li>9. Plug pump into a properly grounded GFCI receptacle.</li> </ol> |
|----------------------------------------------------------------------------------------------------------------------------------------------------------------------------------------------------------------------------------------------------------------------------------------------------------------------------------------------|---------------------------------------------------------------------------------------------------------------------------------------------------------------------------------------------------------------------------------------------------------------------------------------------------------------------------------------------------------------------|

## Do's And Don't's For Installing A Unit

- |                                                                                                                                                                                                                                                                                                                                                                                                                                                                                                                                         |                                                                                                                                                                                                                                                                                                                                                         |
|-----------------------------------------------------------------------------------------------------------------------------------------------------------------------------------------------------------------------------------------------------------------------------------------------------------------------------------------------------------------------------------------------------------------------------------------------------------------------------------------------------------------------------------------|---------------------------------------------------------------------------------------------------------------------------------------------------------------------------------------------------------------------------------------------------------------------------------------------------------------------------------------------------------|
| <ol style="list-style-type: none"> <li>1. DO read all installation material included with the pump.</li> <li>2. DO inspect unit for any visible damage caused by shipping. Contact dealer if unit appears to be damaged.</li> <li>3. DO always disconnect pump from power source before handling. DO always connect to a separately protected and properly grounded ground fault protected circuit. DO NOT ever cut, splice or damage power cord. DO NOT carry or lift pump by its power cord. DO NOT use an extension cord.</li> </ol> | <ol style="list-style-type: none"> <li>4. DO NOT use a discharge pipe smaller than the pump discharge size.</li> <li>5. DO test pump immediately after installation to be sure that the system is working properly.</li> <li>6. DO review all applicable local and national codes and verify that the installation conforms to each of them.</li> </ol> |
|-----------------------------------------------------------------------------------------------------------------------------------------------------------------------------------------------------------------------------------------------------------------------------------------------------------------------------------------------------------------------------------------------------------------------------------------------------------------------------------------------------------------------------------------|---------------------------------------------------------------------------------------------------------------------------------------------------------------------------------------------------------------------------------------------------------------------------------------------------------------------------------------------------------|

## Performance Characteristics

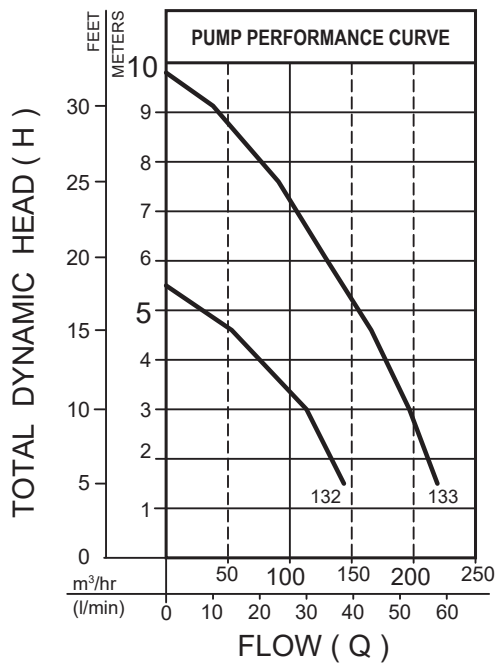

TOTAL DYNAMIC HEAD/FLOW DEWATERING ONLY					
MODEL		132		133	
Feet	Meters	Gal./min	Liters	Gal./min	Liters
5	1.5	38	144	58	220
10	3.0	30	114	52	197
15	4.6	14	53	44	167
20	6.1	---	---	34	129
25	7.6	---	---	24	91
30	9.1	---	---	10	38
Shut-off Head		18ft. (5.5m)		32ft. (9.8m)	

081459

### STEP 1

## Determine Installation Configuration

**NOTE: This preassembled unit is designed for use with an external trap.**

Figure 1 is a typical configuration for installation of the drain system. The actual configuration will vary depending on your cabinet and sink configuration.

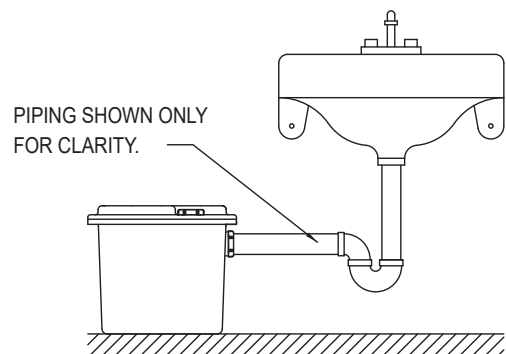

**STANDARD INSTALLATION**

Figure 1

SK2001

## STEP 2

## Final Assembly

NOTE: External plumbing configuration will vary depending on the location of basin, location of main stack and available space.

Place the basin assembly in its final position and complete plumbing. Secure all connections shown in Figure 2.

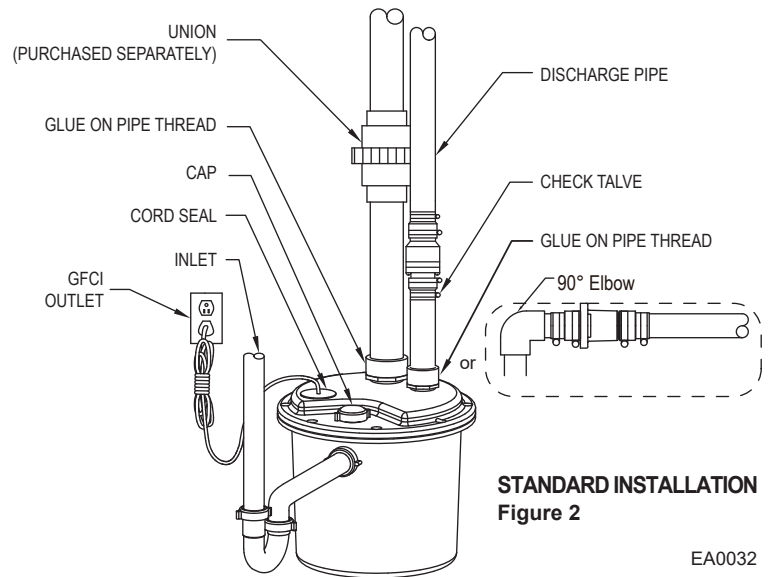

EA0032

## STEP 3

## Initial Testing of Drain Basin System

1. Plug the cord into a properly grounded GFCI receptacle.
2. Fill the basin with 7.5 - 11 liters of water and let sit for 3 - 4 minutes to enable the environmentally safe peanuts to begin dissolving.
3. Slowly fill the basin with water.
4. Check all plumbing for leaks as the basin fills.
5. Verify that the pump starts and stops.
6. Check the discharge line for leaks as the pump empties the basin.
7. Repeat steps 2 through 6 as necessary to ensure proper operation.
8. If problems persist, refer to the troubleshooting guide located on page 2 of this manual.

## Illustrated Parts Breakdown

MODELS 132/133		
ITEM	DESCRIPTION	QTY
1	Drain Pump	1
2	Replacement Pump	1
3	Basin-Tank	1
4	Discharge Tube	1
5	Basin-Lid	1
6	Cap w/o-ring	1
7	Basin Seal	1
8	Unicheck	1
9	Screw S.S.	8
10	Nut S.S.	8
11	Pipe Cap w/o-ring	2
12	O-Ring	2
13	Packing	1
14	*90° Elbow	1

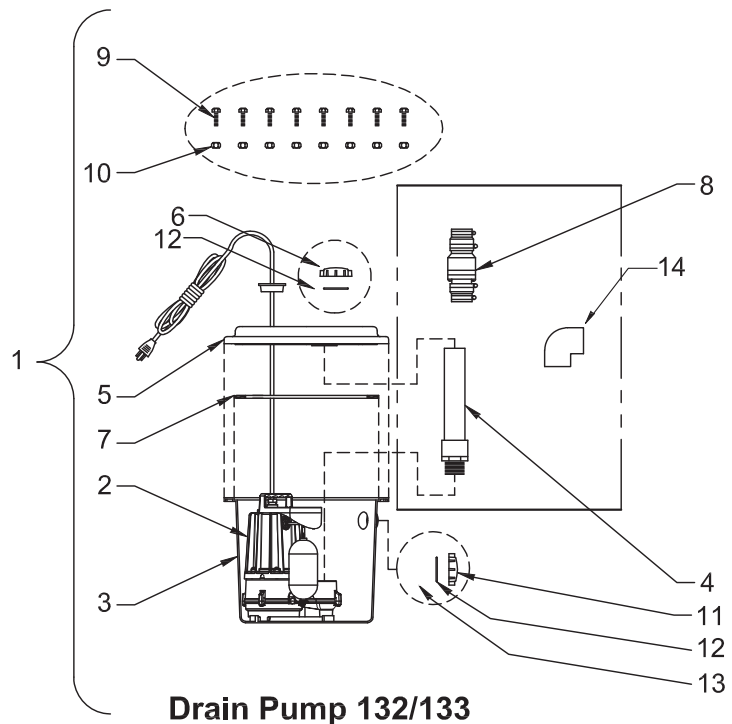

Drain Pump 132/133

\* This is a standard part of a specific model, please refer to the replacement list for details.

EA0033

# 安裝前務必詳讀說明書

Trusted. Tested. Tough.®

文件僅供參考  
若有任何修改  
恕不另行通知

請至美國卓勒泵浦公司  
官網完成您的產品註冊



60 Hz



Visit our website:  
[www.zoellerpumps.com](http://www.zoellerpumps.com)

## 安裝說明書

### 132/133 型預組式污水提升器

## 安裝前檢查

1. 安裝前請仔細檢查所有零件。產品如果在運送中受損，請儘速聯絡經銷商。
2. 安裝前仔細閱讀所有提供的文件，熟悉安裝細節，並保存資料以供未來參考。

 <b>警告</b>	 <b>注意</b>
<ol style="list-style-type: none"><li>1. 為防範使用者觸電，本公司所有產品皆配有包含接地功能的電線及三插插頭。為確保安全，請勿將插頭的接地插銷拔除，並確認將插頭插入符合國內電工法規的漏電保護插座。</li><li>2. 為確保安全請勿使用延長線。加裝延長線容易使泵浦馬達接收不到足夠的電壓。更重要的是，若延長線的絕緣遭破壞、或插頭鬆脫掉入水中，將可能造成危險。</li><li>3. 請在安裝前測試插座的接地功能。為了安全考量，請使用符合國內電工法規的電路測試儀器來檢查插座中的火線、中性線及地線是否配置正確。若發現異常，請聯絡合格的水電技師來為您解決問題。</li><li>4. 為保護安裝者，處理前請切斷泵浦電源。若泵浦電線直接連結至電源線路，切斷控制盒的電路。泵浦由具有三叉的插頭接地，以防止觸電危險。 任何情況下均不得拔除接地接腳。為防止電擊危險，須安裝適當接地的接地型插座，並依國內電工法規及相關規定，以接地漏電電流斷路器保護。</li><li>5. 僅得由有執照的合格電氣技師進行安裝及檢查電路和硬體。</li></ol>	<ol style="list-style-type: none"><li>1. 確認電力足以供應泵浦或識別標籤上所示的所需馬達電流量。</li><li>2. 請確認在供給泵浦電源的電路中加裝適當規格的保險絲或斷路器。在此建議依照泵浦銘牌上的電流值，並參照國內電工法則來選擇及安裝獨立的斷路器。</li><li>3. 須依當地法令規章安裝所有的管道(排放管及通氣管)。裝置必須有通氣設備，勿使用自動管路通氣設備。</li><li>4. 必須安裝止回閥，減少泵浦不必要的循環運轉。</li><li>5. 本產品非設計於處理污物排除。</li><li>6. 最高操作溫度不得超過攝氏40度。</li><li>7. 基於衛生考量，在泵浦斷電、關閉或無法作用後，請勿持續注水灌滿水槽。此非灌滿水槽的適當方式。</li><li>8. 內附止回閥使用的橡膠材質接頭，可承受最大壓力0.3公斤/平方公分(揚程3米)最高溫度攝氏54.4度，若靜落差超過3米，需自行搭配塑料材質接頭。</li></ol> <p>保固請參閱第7頁。</p>

請勿使用於油類、汽油、石油產品或含任何化學成分的液體。

## 保固說明

本產品的保固為自購買日起算的一年、或從工廠製造日期起算的18個月，以先到期者為準。若能證明產品的缺陷是由材料或製造過程造成，本公司將負責維修或更換。本公司保留決定是否維修或更換產品、零件或配件的權利。維修或更換期間買方所產生的費用或損失不在保固範圍內。保固不適用於：

- (1) 未依照說明書安裝、操作或維護所造成的故障或損壞。
- (2) 不當操作、意外或疏忽所造成故障或損壞。
- (3) 加裝不屬於本產品的零、配件。
- (4) 未依照當地法規進行安裝所造成的危害。

(5) 將產品用在非原本設計的用途上所造成的損壞。( 例：抽取沙、碎石、水泥、泥巴、瀝青、碳氫化合物及其衍生物、汽油、化學溶劑或其他有腐蝕性的液體、毛巾、女性衛生用品等。)

保固零、配件的退回：在本保固之下任何修理或更換需送回本公司或其他本公司所指定的維修服務點，運費需自付。在任何情況下本公司不負擔其他責任，包含資產或設備的損壞、利潤損失、等.....。

本公司的責任不超過產品的實售價格。

上述為本產品唯一的保固說明，任何人的修改或另做承諾皆為無效。

在因涉嫌產品故障而招致損害的情況下，財產擁有者必須保留該產品以供調查之用。

## 檢查清單



### 警告

在維修泵浦之前，須關閉總電源斷路器，拔除泵浦插頭——確保人未站在水中，且穿上絕緣保護底的鞋子。在淹水狀況下，聯絡當地的電力公司，或有執照的合格電氣技師，在移除管之前進行斷電。本泵浦含冷卻油，在運作狀態下會受壓變熱——斷電後等待2.5小時再進行維修。如果以下檢查點都無法排除問題，請與本公司連絡，不要嘗試維修或拆除泵浦及其他零件。

異常狀況	可能原因	補救措施
<b>A. 泵浦未開始運作。</b>	低電壓、保險絲燒斷、電路中斷。	由合格電氣技師檢查保險絲和電路。
	葉輪卡住。	聯絡經銷商。
	馬達或電線短路。	
	浮球開關上有雜物。	去除雜物
<b>B. 馬達過熱造成跳電或保險絲燒斷。</b>	電壓錯誤、負揚程(出水口高度低於泵浦)、葉輪或軸封卡死、電容器、繼電器或馬達短路。	聯絡經銷商。
<b>C. 泵浦啟動停止次數太頻繁。</b>	止回閥阻塞、無止回閥、熱過載保護器啟動或浮子有瑕疵。	聯絡經銷商。
<b>D. 泵浦不停止。</b>	浮球下方有雜物。	去除浮球周圍的雜物。
	浮球開關故障。	聯絡經銷商。
<b>E. 泵浦運轉正常，但抽不到水或水流量太少。</b>	進水口周圍有雜物。	清理進水口附近區域。
	排放管堵塞。	必要時卸除排放管，沖走雜物。
	電壓太低或不當電壓。	由合格電氣技師檢查家庭管線。
	葉輪受損。	聯絡經銷商。
	馬達運轉不當、電容器瑕疵、入水含空氣或造成空氣進入水機室。	聯絡經銷商。
	泵浦氣鎖。	確保排放管中的通氣孔暢通。
<b>F. 揚程或流量使用一般時間後降低。</b>	安裝揚程超過系統設計的揚程。	更換排放管或聯絡經銷商。
	管路或止回閥阻塞。磨蝕性物質及有害的化學物質造成葉輪及水機損壞。	檢查管路、打開並檢查水機。
<b>G. 桶槽或配件漏水。</b>		小心鎖緊管路連接處(用水管潤滑劑)及螺絲，檢查墊片位置，平均的鎖緊上蓋，切勿過度施力鎖的太緊。

如果檢查后仍無法排除問題，請與經銷商連絡，切勿自行拆卸水泵。

## 輕鬆安裝的要訣

1. 安裝前閱讀所有指示。
2. 確保安裝地面平坦。
3. 請避免使用自動管道通氣設備。
4. 出水口管路上必須安裝止回閥。
5. 依下列安裝步驟 3 完成泵浦測試。
6. 活動式配管以確保日後維修時方便拆除。
7. 務必至少一個月確認泵浦有正常運轉一次。
8. 型號及日期碼標籤貼於桶身。
9. 確保插座有電源斷路器設計。

## 安裝注意事項

1. 請務必閱讀本裝置之所有安裝資料。
2. 請務必檢查裝置是否在運送中產生可見的損壞。若裝置顯示受損，請洽經銷商。
3. 處理前切斷泵浦電源。連結到獨立受保護的接地漏電電流斷路器。請勿切斷、拼接或損壞電源線。請勿用電源線拉動或舉起泵浦。請勿使用延長線。
4. 切勿使用小於出水口徑尺寸的水管安裝。
5. 請務必在安裝後立即測試泵浦，以確認系統正常運作。
6. 請務必詳閱所有適用當地及國家規則，確認安裝符合各項規定。

## 性能曲線

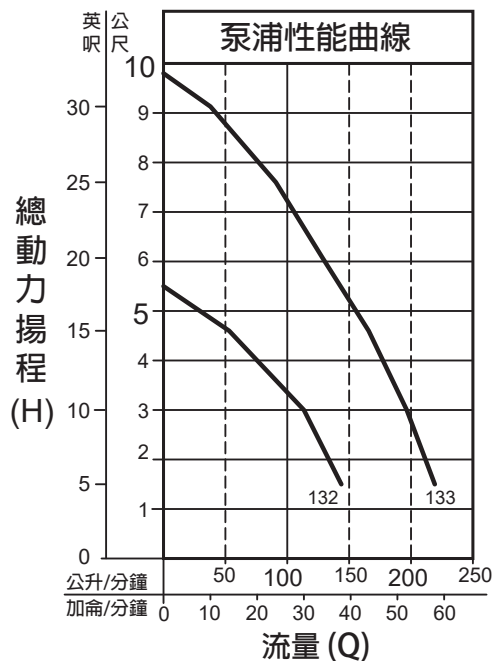

總動力揚程 / 每分鐘流量					
型號		132		133	
英呎	公尺	加侖	公升	加侖	公升
5	1.5	38	144	58	220
10	3.0	30	114	52	197
15	4.6	14	53	44	167
20	6.1	---	---	34	129
25	7.6	---	---	24	91
30	9.1	---	---	10	38
全閉揚程		18英呎(5.5公尺)		32英呎(9.8公尺)	

081459

## 步驟 1

## 安裝步驟

注意：預組式產品限用於彎管側接入水。

圖 1 為污水提升器標準式安裝，僅供參考，實際安裝仍需依洗手台等現場為主調整。



圖 1  
標準安裝

SK2001

## 步驟 2

## 組裝圖示

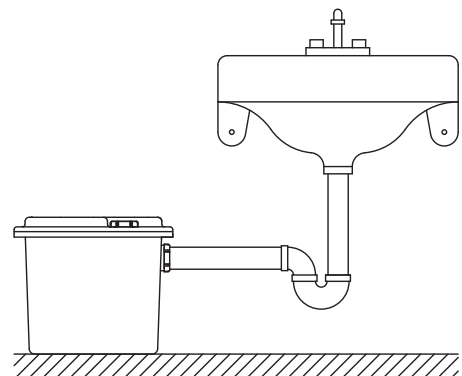
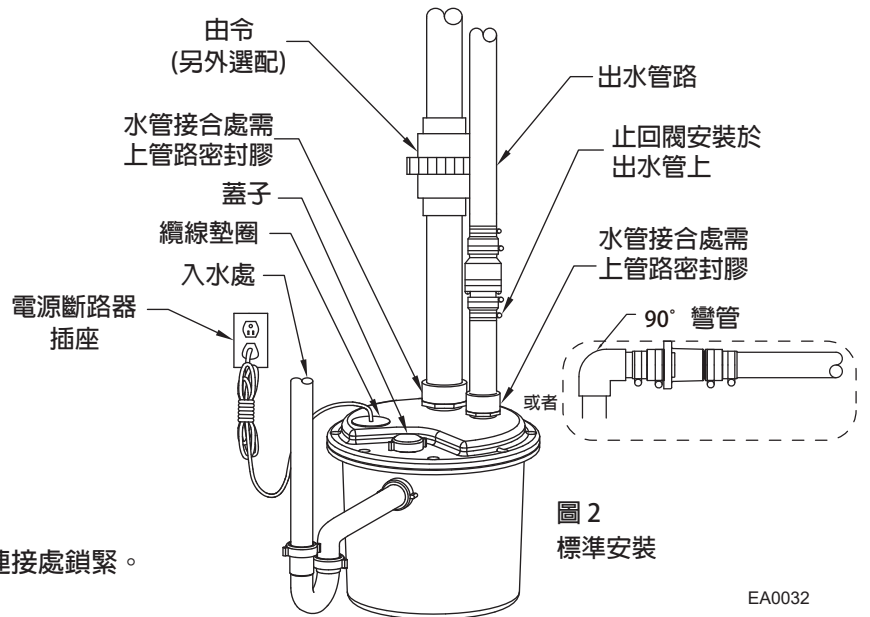

注意：實際外部管路結構，依現場空間大小與本產品相對位置而定。

將圖 2 組裝定位並完成接管，確認所有連接處鎖緊。

圖 2  
標準安裝

EA0032

## 步驟 3

## 首次啟用測試步驟

1. 插頭插入電源斷路器插座。
2. 加入7.5-11公升的水後，靜置3-4分鐘。
3. 慢慢再加入水。
4. 檢查所有管路在注水時是否會漏水。
5. 確認泵浦正常啟動和停止運作。
6. 檢查泵浦運作時出水管是否漏水。
7. 視情況重覆要點2-6的步驟，以確保安裝無誤。
8. 如有發生問題，請參照第2頁異狀排除指示操作。

## 零件分解圖示

132/133型		
項目	品名	數量
1	污水提升器	1
2	替換泵浦	1
3	桶子	1
4	出水管	1
5	桶蓋	1
6	O型環蓋	1
7	桶身密封件	1
8	止回閥	1
9	*不鏽鋼螺絲	8
10	*不鏽鋼螺母	8
11	*入水蓋附O型環	2
12	*O型環	2
13	*迫緊	1
14	*90° 彎管	1

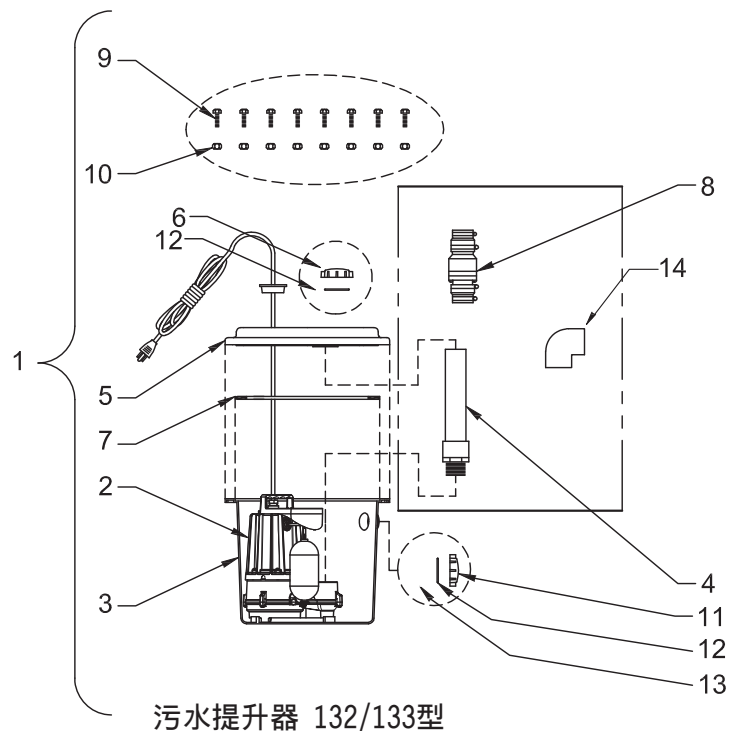

污水提升器 132/133型

\*此為特定型號的標準配件，詳情請參閱更換清單。

EA0033